

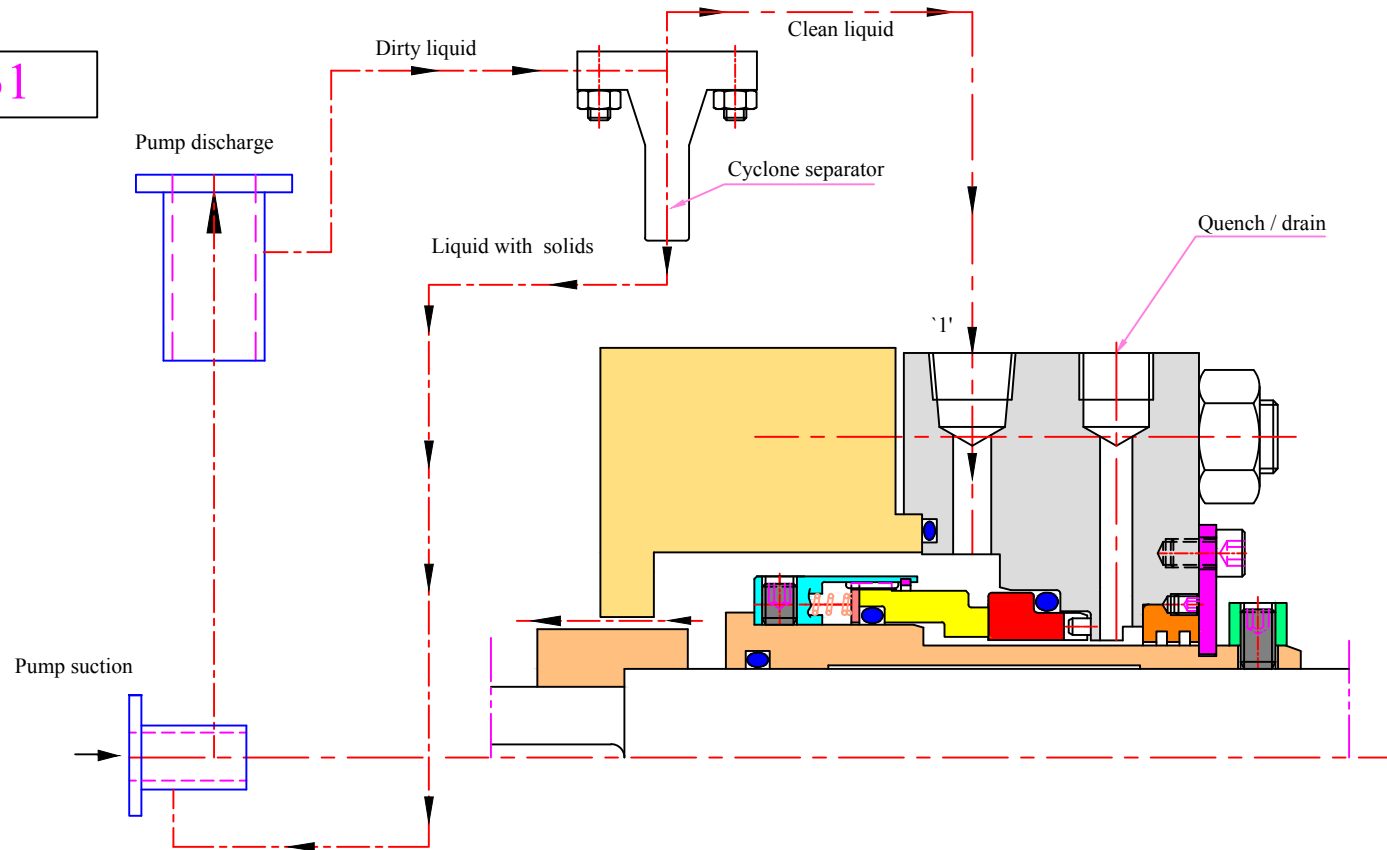

API PLAN - 31



- Recirculation from pump discharge through a cyclone separator delivering the clean fluid to the seal chamber
- The abrasive solids are delivered to pump suction line.
- Seal chamber heat removal.
- Solids do not enter the flush line and seal chamber.
- Connection '1' for flushing inlet.
- For dirty or contaminated fluids, water with sand or pipe slag.
- Non-polymerizing fluids.